

RA-2 750

TECHNICAL SHEET

AIR KNIVES

SINGLE FLOW



OPERATING PRINCIPAL

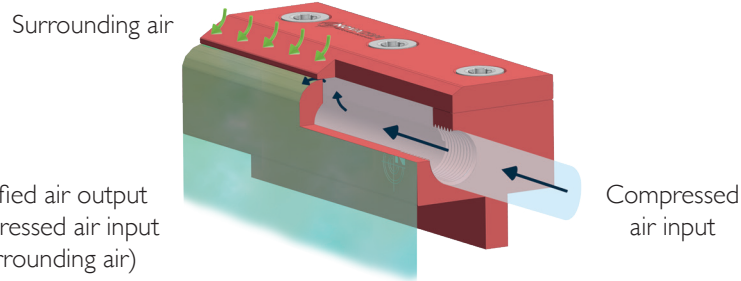

Economical

UP TO
93%
SAVINGS IN AIR
CONSUMPTION

TECHNICAL INFORMATION*

BENEFITS OF USING THE RA-2 750 AIR KNIFE* (Compared to an open pipe)		Reduction in air consumption (%)		Noise reduction (%)		
		Up to 93%		Up to 34%		
PERFORMANCES AIR KNIFE RA-2 750*	Pressure (bar)	Air consumption (l/mn)	Blowing force (N)		Noise level (dB)	Amplified air (l/min)
			at 150mm	at 450mm		
	2	1630	6,1	5,6	86	40750
	6	3600	15,9	15,5	95	90000
VS OPEN PIPE Ø8* (opened on 750mm)	Pressure (bar)	Air consumption (l/mn)		Noise level (dB)	Amplified air (l/min)	
	6	22700		130	22700	

RA-2 750 AIR KNIFE FEATURES

- **Connection :** Female G1/4" • **Weight :** Aluminium : 1 570g • **Max. operating temperature :** Aluminium : 150°C • **Max pressure :** 10 bars

AMPLIFIED AIRSTREAM DEPENDING ON PRESSURE*

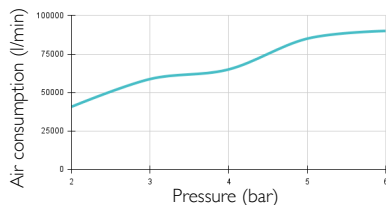

BLOWING FORCE AT 150 MM DEPENDING ON PRESSURE*

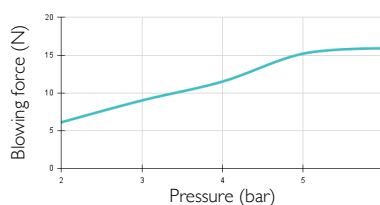

BLOWING FORCE AT 450 MM DEPENDING ON PRESSURE*

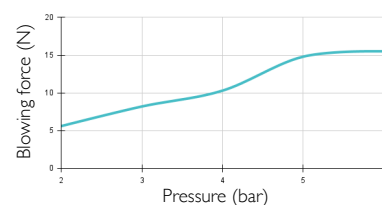

AIR CONSUMPTION DEPENDING ON PRESSURE*

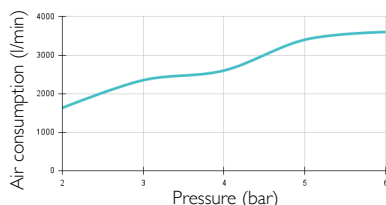

Amplified blowing

G 1/4" air input

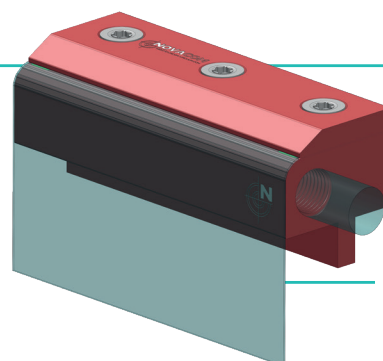

* **NOTE:** The measurements in this data sheet have been obtained in a laboratory **under strict control**. The varying conditions of a real industrial environment and the instability of pressure from an industrial compressor can create different values than the ones obtained in a laboratory. Those data are provided for information purposes only. To achieve the best performance from the air knives, we recommend using a compressed air supply tube with a minimum 8 mm inside.

DIMENSIONS

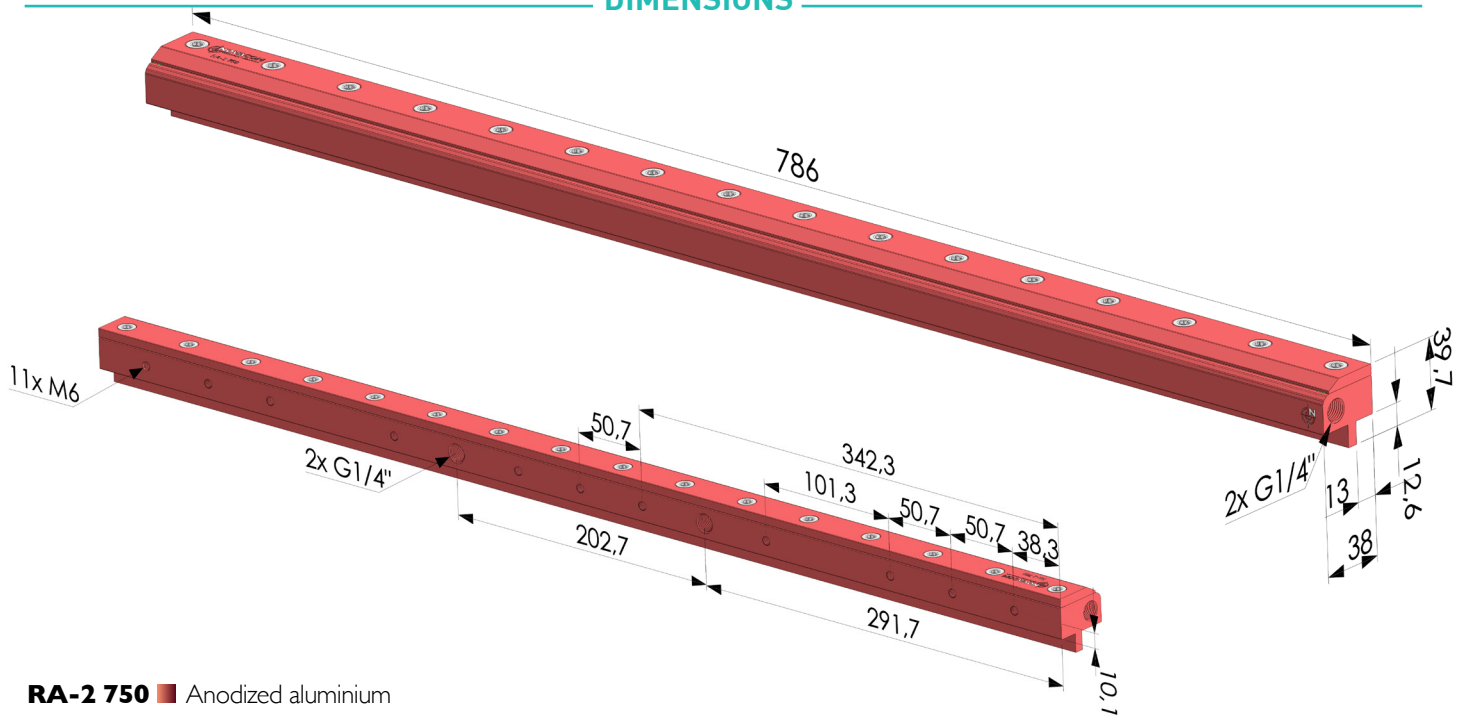

RA-2 750 ■ Anodized aluminium

The values are given in millimeters