

**TECHNICAL INFORMATION**

- Range :** Suction cup  
**Category :** Plates  
**Series :** 5  
**Height (in mm) :** 11  
**Shape :** Plate  
**Contact lip diameter :** 12 mm  
**inner barrel diameter :** 4 mm  
**Number of bellows :** 0.5 Bellows  
**Horizontal force :** 5.14 N  
**Vertical force :** 2.57 N  
**Arrow :** 2mm

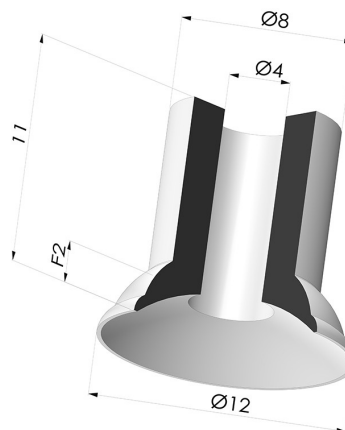

**Variants:**



Variant reference:  
**5 12CN A**

- Color: Brown FDA food certified
- Matter: Natural rubber
- Shore Hardness: SH40



Variant reference:  
**5 12SL A**

- Color: Red food-grade CE certification
- Matter: Silicone
- Shore Hardness: SH60



Variant reference:  
**5 12NI A**

- Color: Black
- Matter: Nitrile
- Shore Hardness: SH50



Variant reference:  
**5 12SLT A**

- Color: Translucent
- CE food certified
- Matter: Silicone
- Shore Hardness: SH60



Variant reference:  
**5 12SLB A**

- Color: White
- FDA and CE food-grade certified
- Matter: Silicone
- Shore Hardness: SH40

**Related products:**



**Separable Male Fitting M5**

Product reference: 9MM5



**Separable Female Fitting G1/8"**

Product reference: F18C12L20



**Separable Male Fitting G1/8"**

Product reference: M18C12L20