

TECHNICAL INFORMATION

- Range :** Suction cup
Category : With bellows
Series : 8
Height (in mm) : 37
Shape : 3.5 Bellows
Contact lip diameter : 32 mm
inner barrel diameter : 8mm
Number of bellows : 3.5 Bellows
Horizontal force : 34 N
Vertical force : 17 N
Arrow : 17 mm

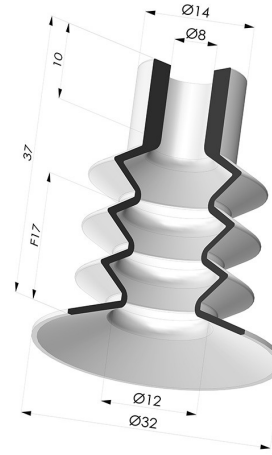

Variants:



Variant reference:
8 32SLT A SH40

- Color: Translucent
- CE food certified
- Matter: Silicone
- Shore Hardness: SH40



Variant reference:
8 32SLT A

- Color: Translucent
- CE food certified
- Matter: Silicone
- Shore Hardness: SH50



Variant reference:
8 32NI A

- Color: Black
- Matter: Nitrile
- Shore Hardness: SH50



Variant reference:
8 32CN A

- Color: Brown FDA food certified
- Matter: Natural rubber
- Shore Hardness: SH35

Material guide:

	Material	Code	Temperature resistance (°C)	Flexibility	Abrasion resistance	UV/Weather resistance	Oil resistance	Food compatibility	Migration test
	Silicone Translucent (Shore SH40)	SL T	-60/+250	✓✓✓	✓	✓✓✓	✓	FDA **	✗
	Nitrile Black (Shore SH50)	NI	-10/+80	✓	✓	✗	✓✓	✗	✗
	Natural rubber Brown FDA food certified (Shore SH35)	CN	-20/+70	✓✓✓	✓✓	✗✗	✗✗	FDA **	✗

Requests for FDA and/or EC certificates must be made AT THE TIME OF ORDER. Any later request will incur additional charges. To meet the expectations of our industrial customers, NOVACOM offers the widest range of elastomer and thermoplastic materials. We can also develop new materials based on precise specifications, in order to solve specific applications for our customers.

Excellent | Good | Low | Poor | Not recommended
 *FDA and/or EC certificate may be requested for various references at the time of order; please contact us.
 ** Food contact certification: (EC) 1935/2004 - (FDA) 21 CFR 177.2600
 *** Food contact certification: (EC) 10/2011 - (FDA) 21 CFR

Related products:

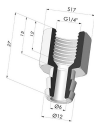

Separable Female Fitting G1/4"

Product reference: D



Separable Male Fitting G1/4"

Product reference: E

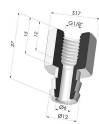

Separable Female Fitting G1/8"

Product reference: H



Separable Male Fitting G1/8"

Product reference: I



Separable Male Fitting M6

Product reference: M6C17