

TECHNICAL INFORMATION

- Range :** Suction cup
Category : With bellows
Series : 8
Height (in mm) : 44
Shape : 4.5 Bellows
Contact lip diameter : 25 mm
inner barrel diameter : 13.5mm
Number of bellows : 4.5 Bellows
Horizontal force : 20 N
Vertical force : 10 N
Arrow : 22 mm

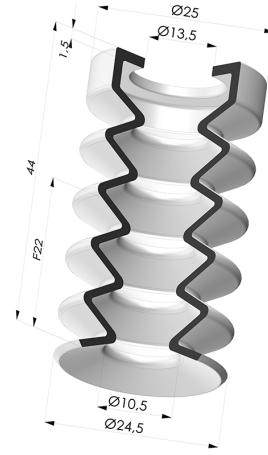

Variants:



Variant reference:
83 25SLT A

- Color: Translucent
- CE food certified
- Matter: Silicone
- Shore Hardness: SH60



Variant reference:
83 25SLT A SH40

- Color: Translucent
- CE food certified
- Matter: Silicone
- Shore Hardness: SH40

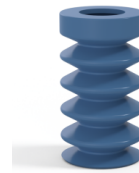

Variant reference:
83 25SLBLEU A SH30

- Color: Blue food-grade CE certification
- Matter: Silicone
- Shore Hardness: SH30

Material guide:

	Material	Code	Temperature resistance (°C)	Flexibility	Abrasion resistance	UV/Weather resistance	Oil resistance	Food compatibility	Migration test
	Silicone Translucent (Shore SH60)	SL T	-60/+250	✓✓✓	✓	✓✓✓	✓	FDA **	✗
	Silicone Translucent (Shore SH40)	SL T	-60/+250	✓✓✓	✓	✓✓✓	✓	FDA **	✗
	Silicone Blue food-grade CE certification (Shore SH30)	SLBLEU	-60/+250	✓✓✓	✗	✓✓✓	✗	FDA **	A, B, D2

Requests for FDA and/or EC certificates must be made AT THE TIME OF ORDER. Any later request will incur additional charges. To meet the expectations of our industrial customers, NOVACOM offers the widest range of elastomer and thermoplastic materials. We can also develop new materials based on precise specifications, in order to solve specific applications for our customers.

Excellent | Good | Low | Poor | Not recommended
 *FDA and/or EC certificate may be requested for various references at the time of order; please contact us.
 ** Food contact certification: (EC) 1935/2004 - (FDA) 21 CFR 177.2600
 *** Food contact certification: (EC) 10/2011 - (FDA) 21 CFR

Related products:



Adaptor - Male G1/4" - Female G1/8"

Product reference: M14T27L13



Screw 1/8G - Head Ø 25 mm - L 11 mm

Product reference: M18T25L11



Adaptor - Male G3/8" - Female G1/8"

Product reference: M38T27L13